

chapter2bikes.com



CHAPTER 2 SPORT LIMITED
46 Patteson Avenue, Mission Bay 1071, Auckland, New Zealand

TOA - INSTRUCTION MANUAL

Contents

Parts List	02
Torque Specifications	03
Shimano Di2 Option	04
Mechanical Shifting Option	05
Seatclamp & Saddle Rail Assembly	06
Seatpost Details	07
Fork	08
Fork / Stem Assembly	09
Di2 & Mechanical Shifting	10
Spacers Specifications	11
Standard Stem / MANA	12-13

Parts List

Torque Specifications

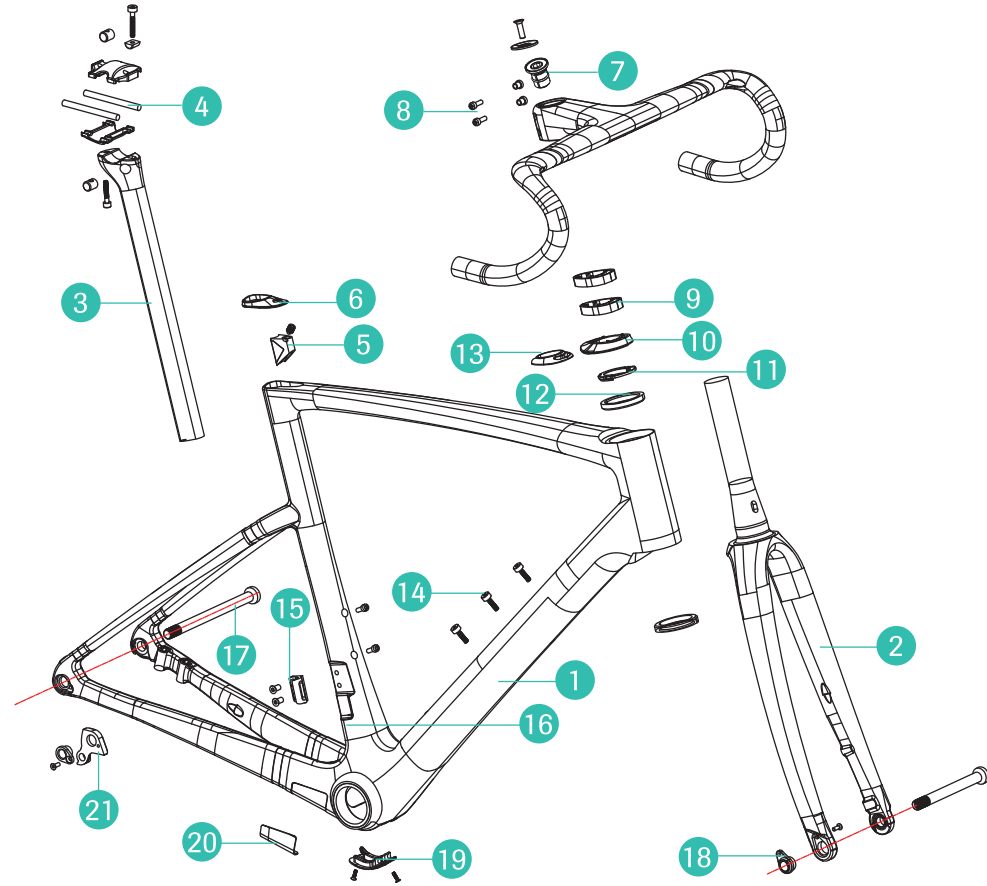

1	TOA Disc Brake Frame
2	TOA Disc Fork
3	TOA Seatpost
4	Saddle Rail Clamp (6Nm)
5	Seatclamp (8-10Nm)
6	Seatpost Water Seal
7	Headset Top Cap and Bolt (2-3Nm), Expander (5-7Nm)
8	MANA2 Stem Bolt (6Nm)
9	Spacers (3x10mm & 3x5mm)
10	TOA Headset Cover
11	Headset Compression Ring
12	Headset Bearing
13	External Cabling Exit Cover
14	Water Bottle Cage Bolt (2-3Nm)
15	Front Derailleur Hanger (3-4Nm)
16	Cable Stop
17	CHAPTER2 Thru Axle Front: 12 x 100mm Rear: 12 x 142mm Pitch: M12 x 1.5mm (10-12Nm)
18	Fork Removable Thru Axle Drop Out (2-3Nm)
19	Cable Routing Access Cover (1-2Nm)
20	Stainless Steel Alloy Guard
21	Rear Derailleur Hanger (2-3Nm)

Shimano Di2 Option

We recommend that electric cables and junction boxes be installed after the brake hose. These routing recommendations are to be used in conjunction to groupset manufacturers' installation instructions. Refer to groupset manufacturers' instructions and/or website for more information.

● Brake ● Di2 Wire

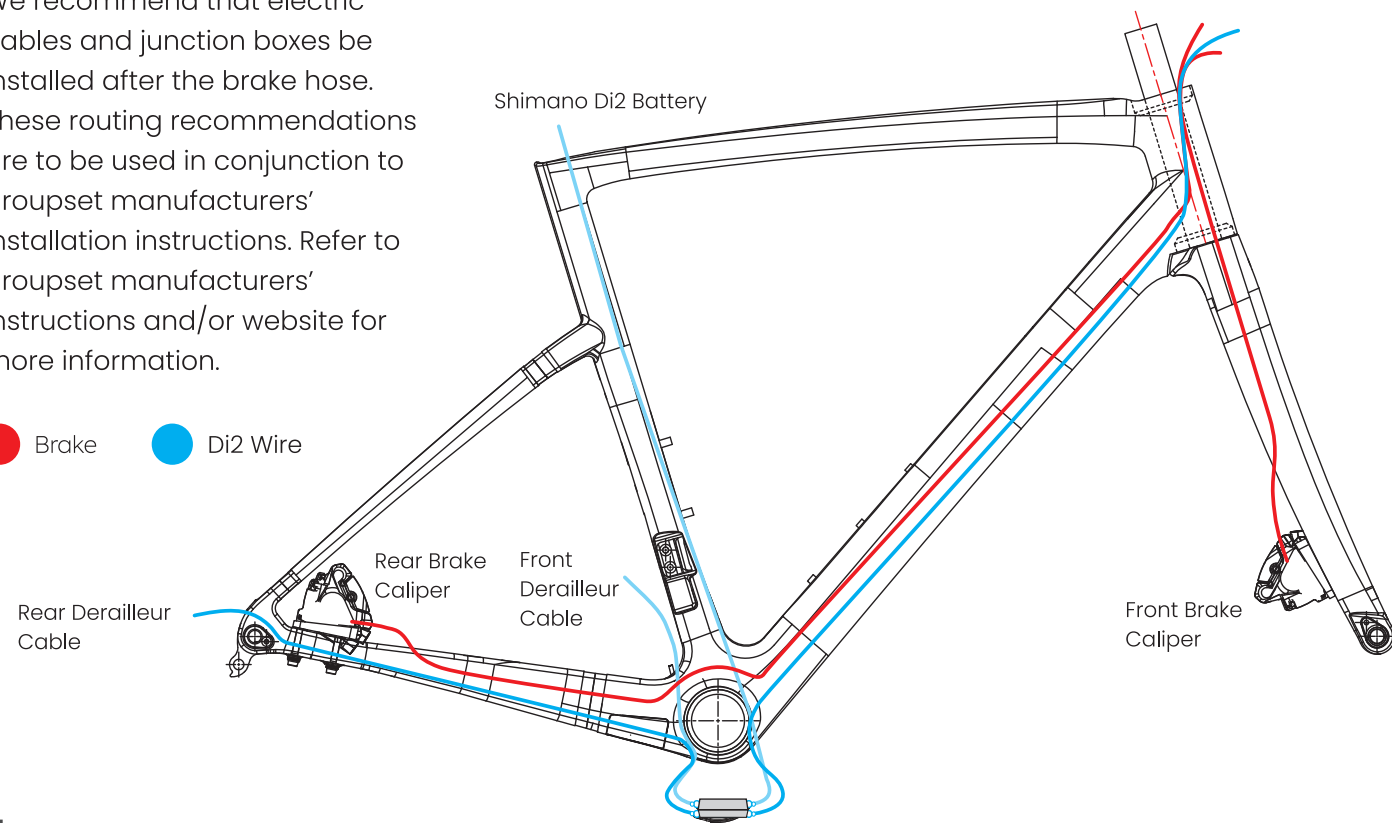

04

Mechanical Shifting Option

We recommend that brake hose or brake cable housing be installed first. These routing recommendations are to be used in conjunction to groupset manufacturers' installation instructions. Refer to groupset manufacturers' instructions and/or website for more information.

● Brake ● Shifting

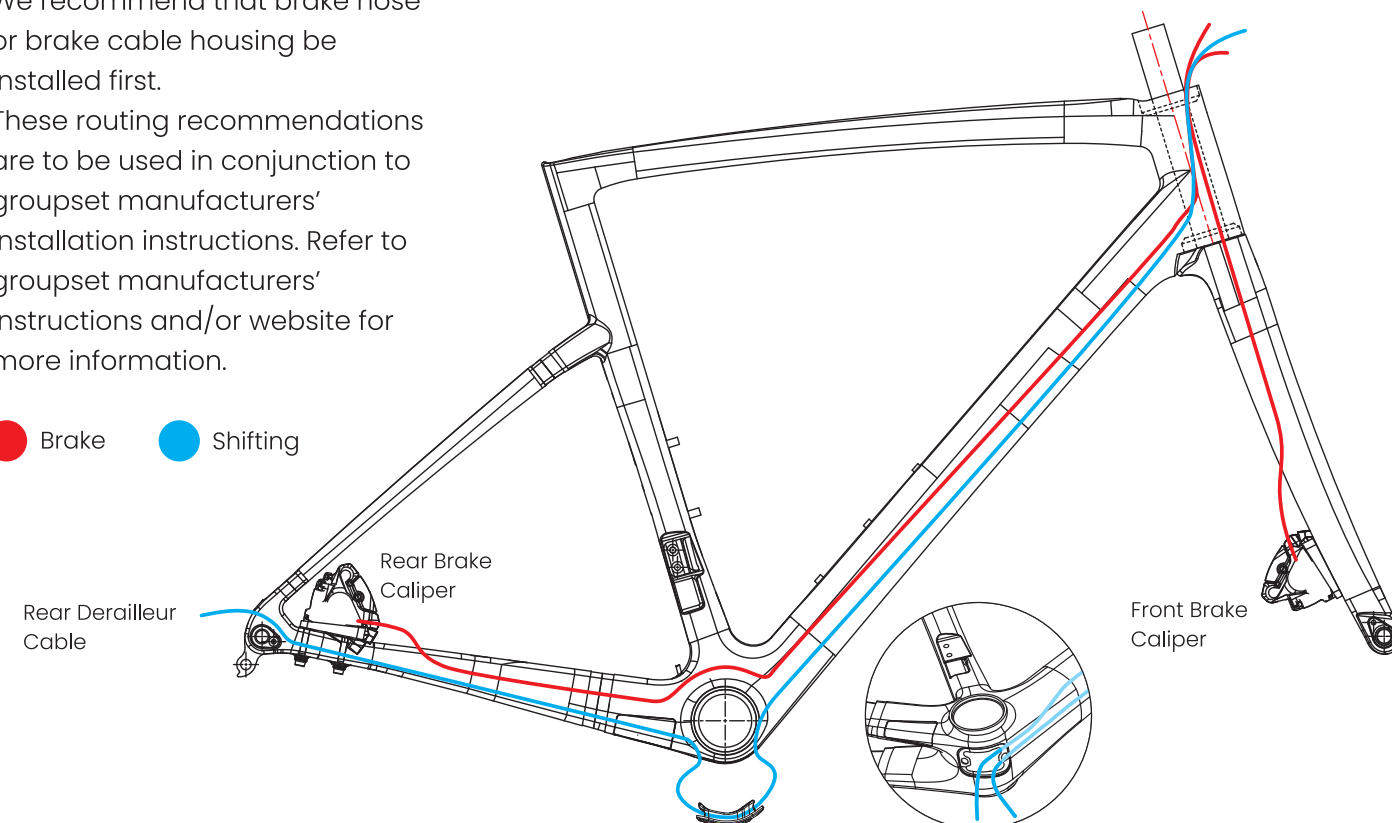

05

Seatclamp & Saddle Rail Assembly

1. Use small amount of carbon friction paste to the radius on the upper face of the seatpost.
2. Apply light coat of grease on contact surface of both bolt and nuts.
3. Install the lower saddle clamp base, as per the diagram.
4. Locate saddle rails between upper and lower clamping surfaces.
5. Establish desired saddle angle by first using adjustment wheel.
6. Tighten opposing angle adjusting screw to secure saddle at 6Nm.
7. Tighten seatpost clamp screw to secure seatpost at 8-10Nm.

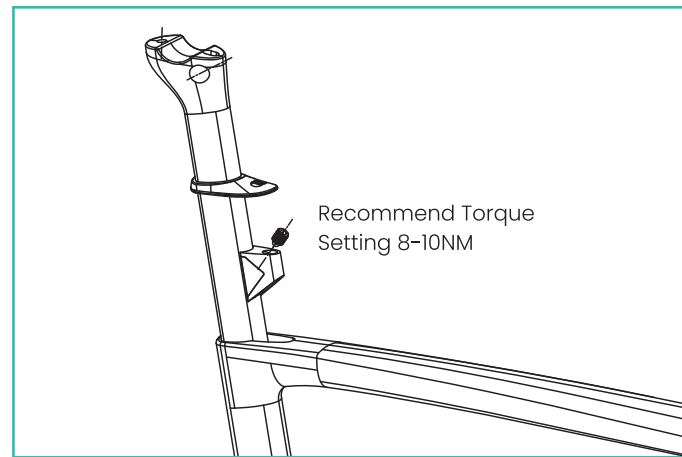
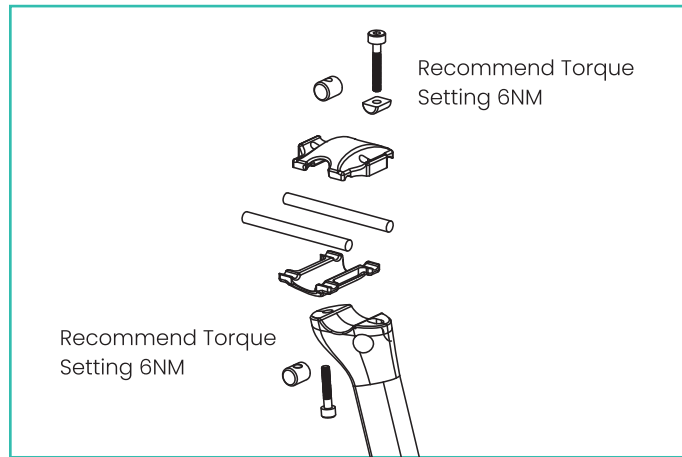

Seatpost Details

1. Use a pencil to carefully mark the seatpost before cutting it to the required length ensuring a minimum of 65mm of seatpost is always inside the frame's seattube, measured from the top surface of top tube.
2. Use a Park Tool SG-Z2 Saw Guide (or equivalent) to carefully secure the seatpost in a vice before cutting the seatpost with a blade that is designed specifically for cutting carbon fibre.
3. Use fine grit sandpaper to carefully remove any fraying or burring from the cut end.
4. Carefully sand the end and after applying carbon friction paste, insert seatpost into the frame.

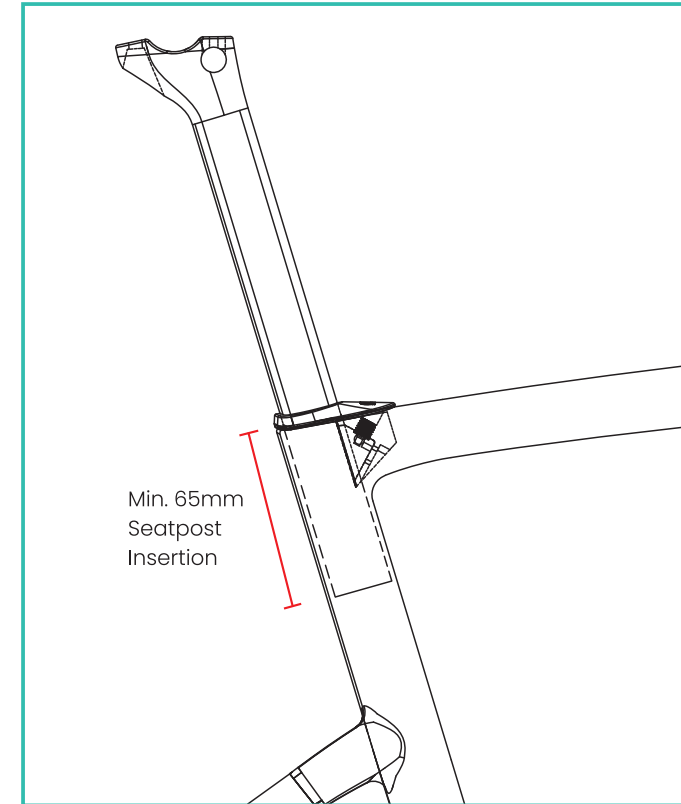

There should always be minimum of 65mm of the seatpost inside the frame when measured from the top surface of the toptube. Failure to meet this requirement, may result in damage to the frame and void the warranty, or cause serious injury to rider.

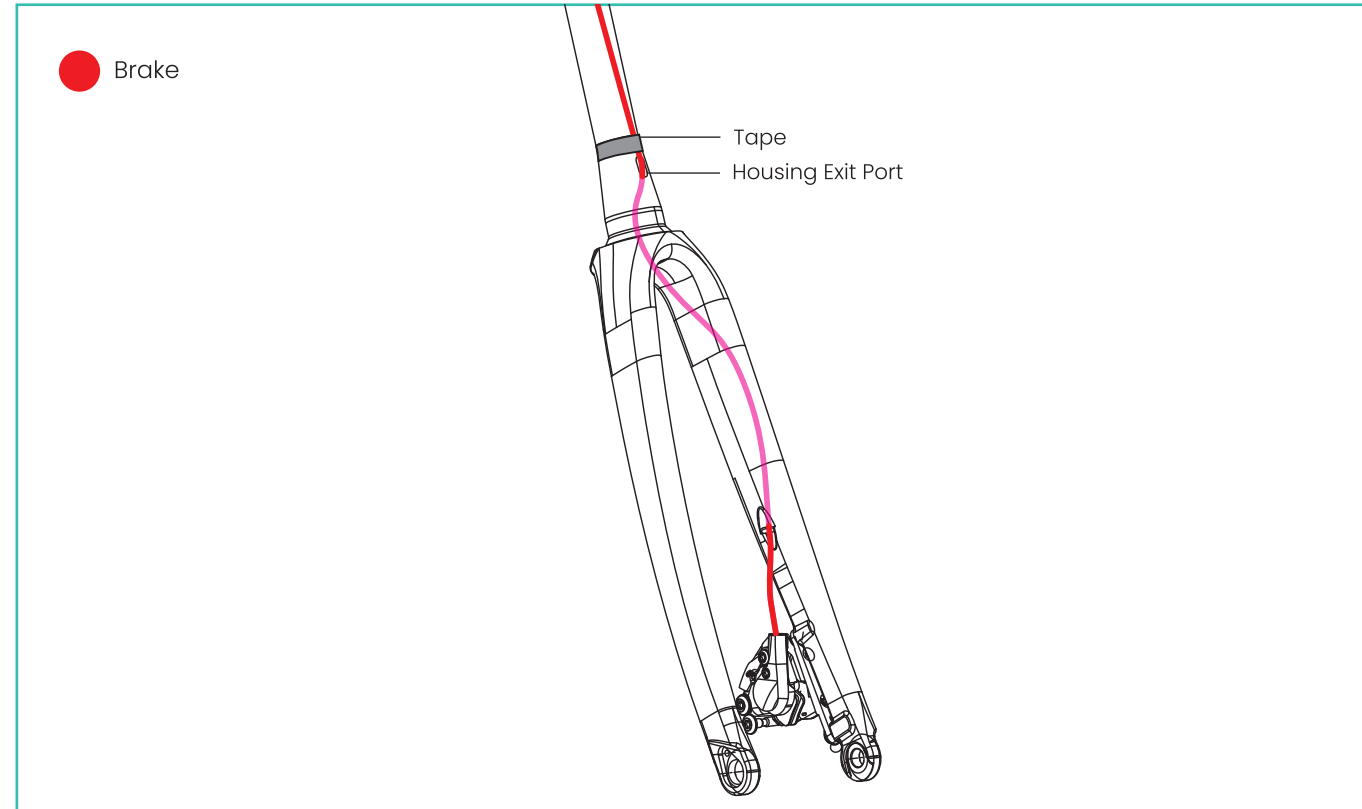

Route the front brake housing :

1. Run the front brake housing through the steering tube to the exit on fork leg.
2. Install the caliper on the fork leg. Torque the caliper bolts according to brake manufacturer's instruction.
3. Once the brake is mounted to the fork. Use a strong adhesive tape to secure the cable housing.

Di2 and Mechanical Shifting

1. With lower bearing installed on the fork, slide the steerer tube and brake hose up through the bottom of the head tube.
2. Install upper bearing, headset compression ring and headset cover. Make sure the brake hoses and the derailleur housing(s) are positioned in the top tube as follows.

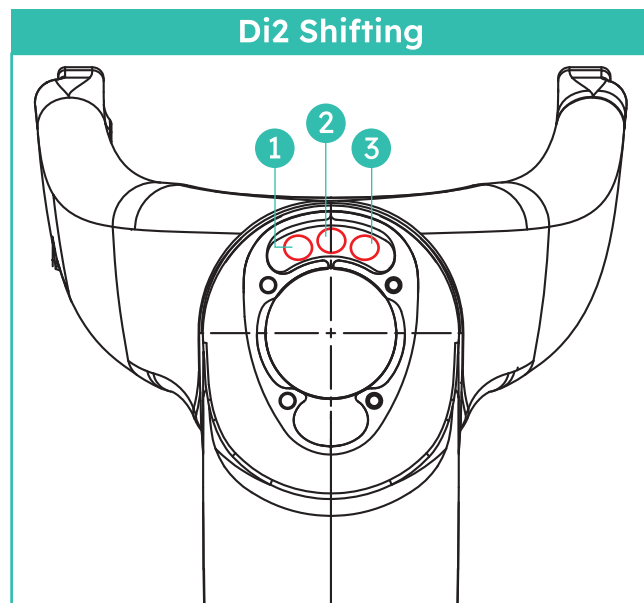

- 1 Front Brake
- 2 Rear Brake
- 3 Di2 Wire

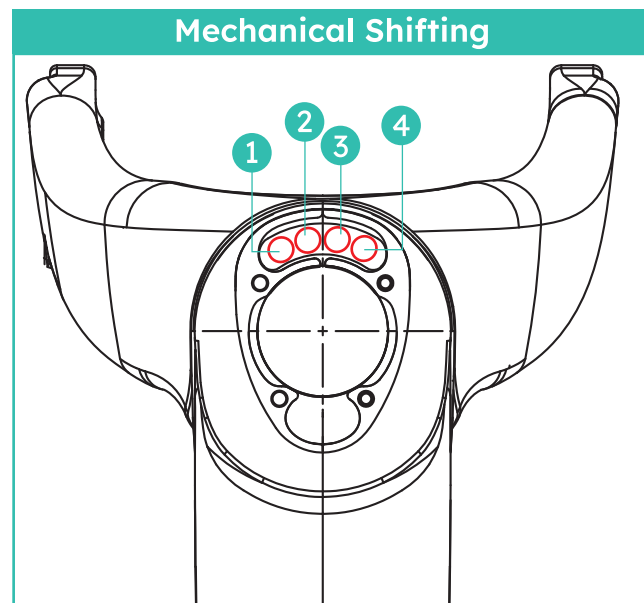

- 1 Front Brake
- 2 Rear Brake
- 3 Front Derailleur Shifting
- 4 Rear Derailleur Shifting

Spacers Specifications

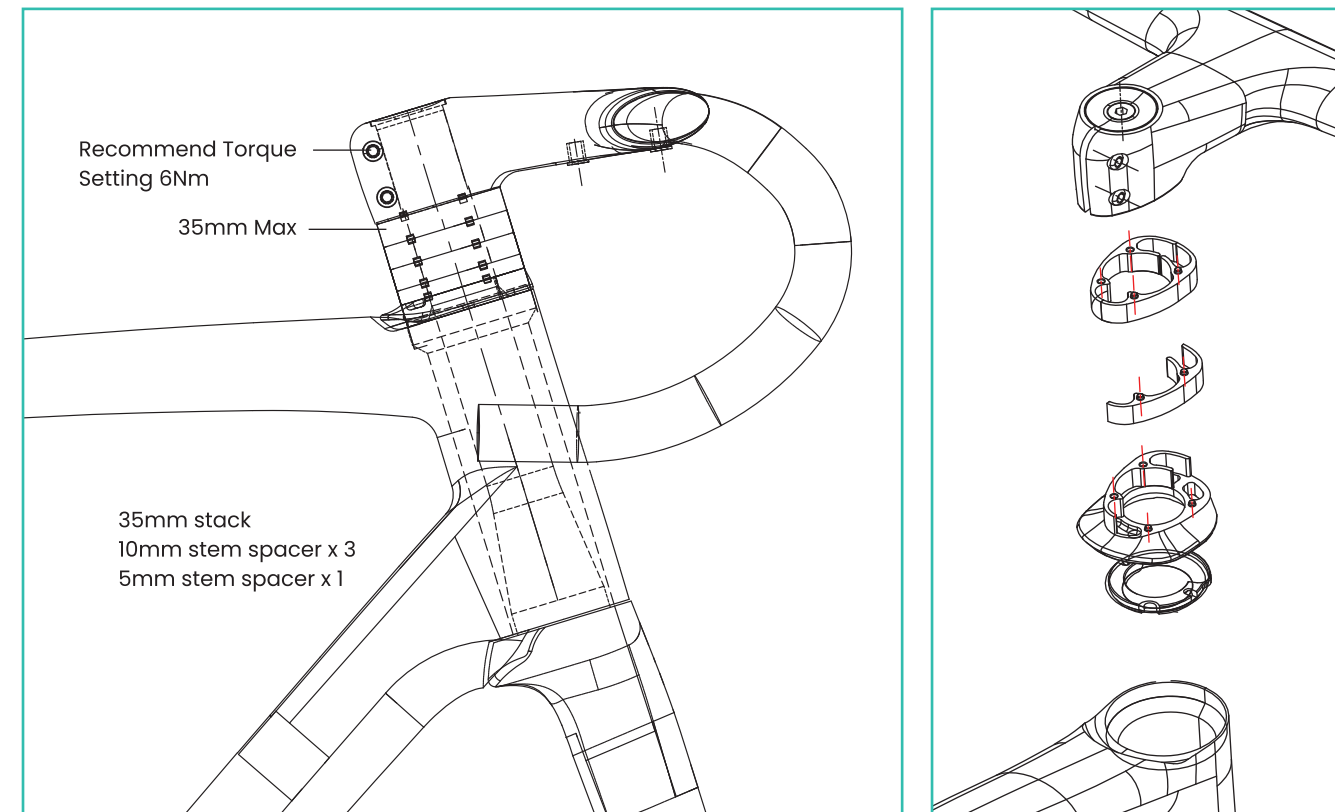

Standard Stem / MANA

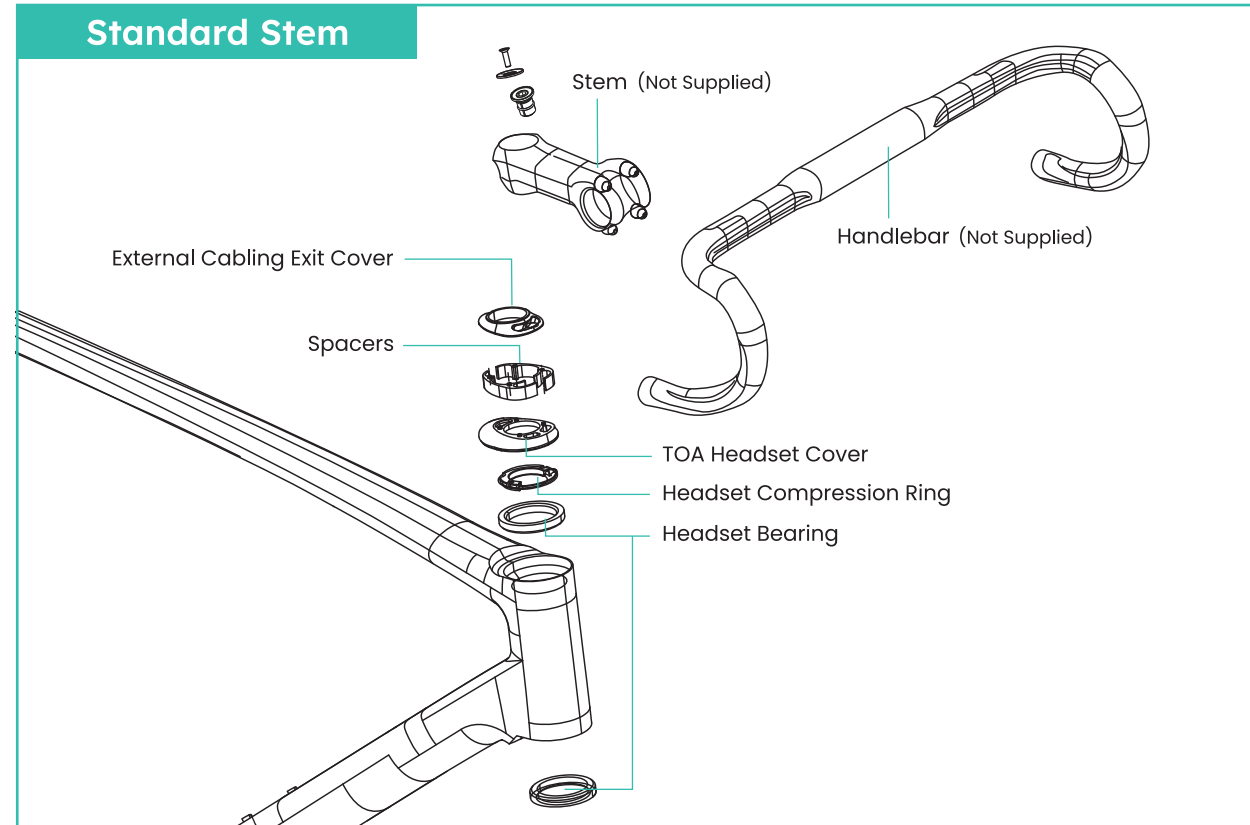

12

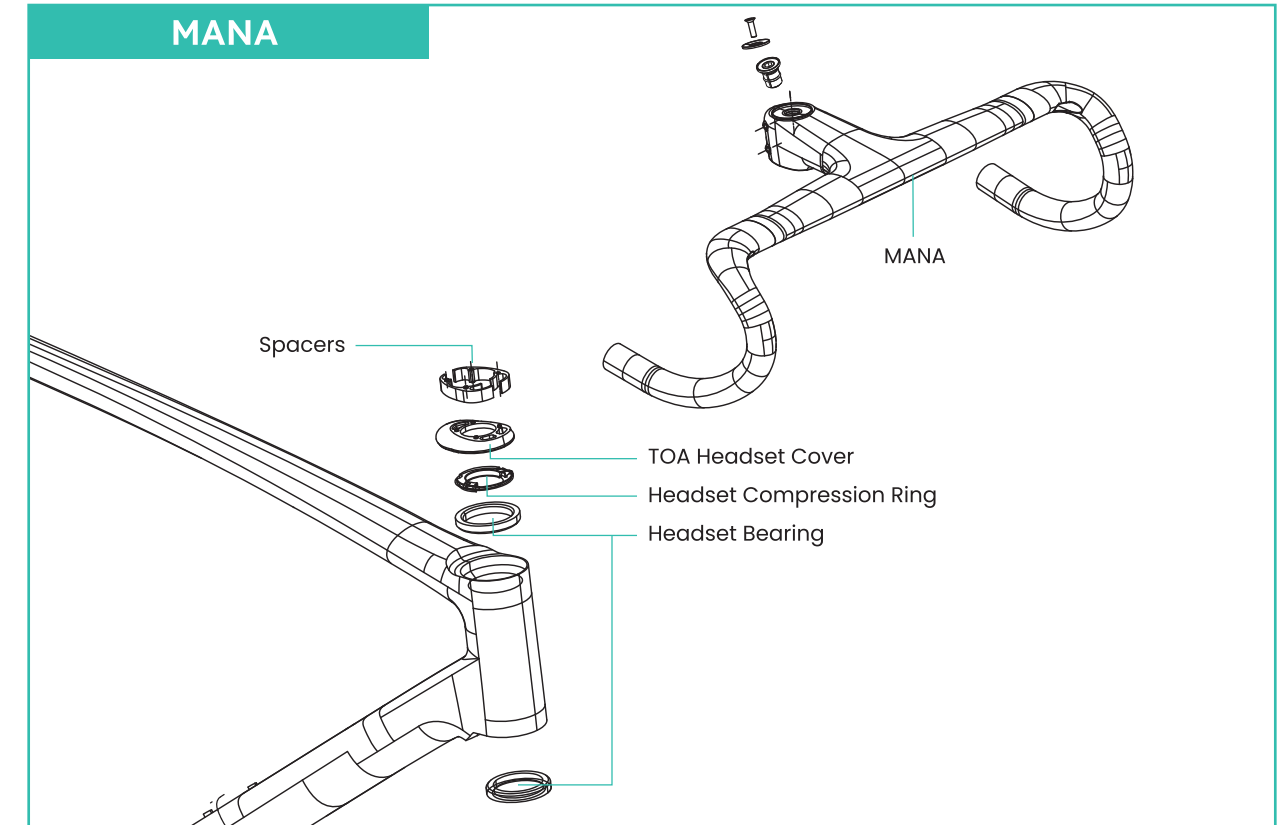

13